

NOT FOR CONSTRUCTION

SITE USE PLANS
 2240 N 375 EAST ROAD,
 VILLAGE OF DE LAND, ILLINOIS 61839

PROJECT NUMBER:
 907-0263

REV	DATE	DESCRIPTION	CHECKED	RELEASE LEVEL
11/29/18	MAS	KJS SITE USE PLAN SET		

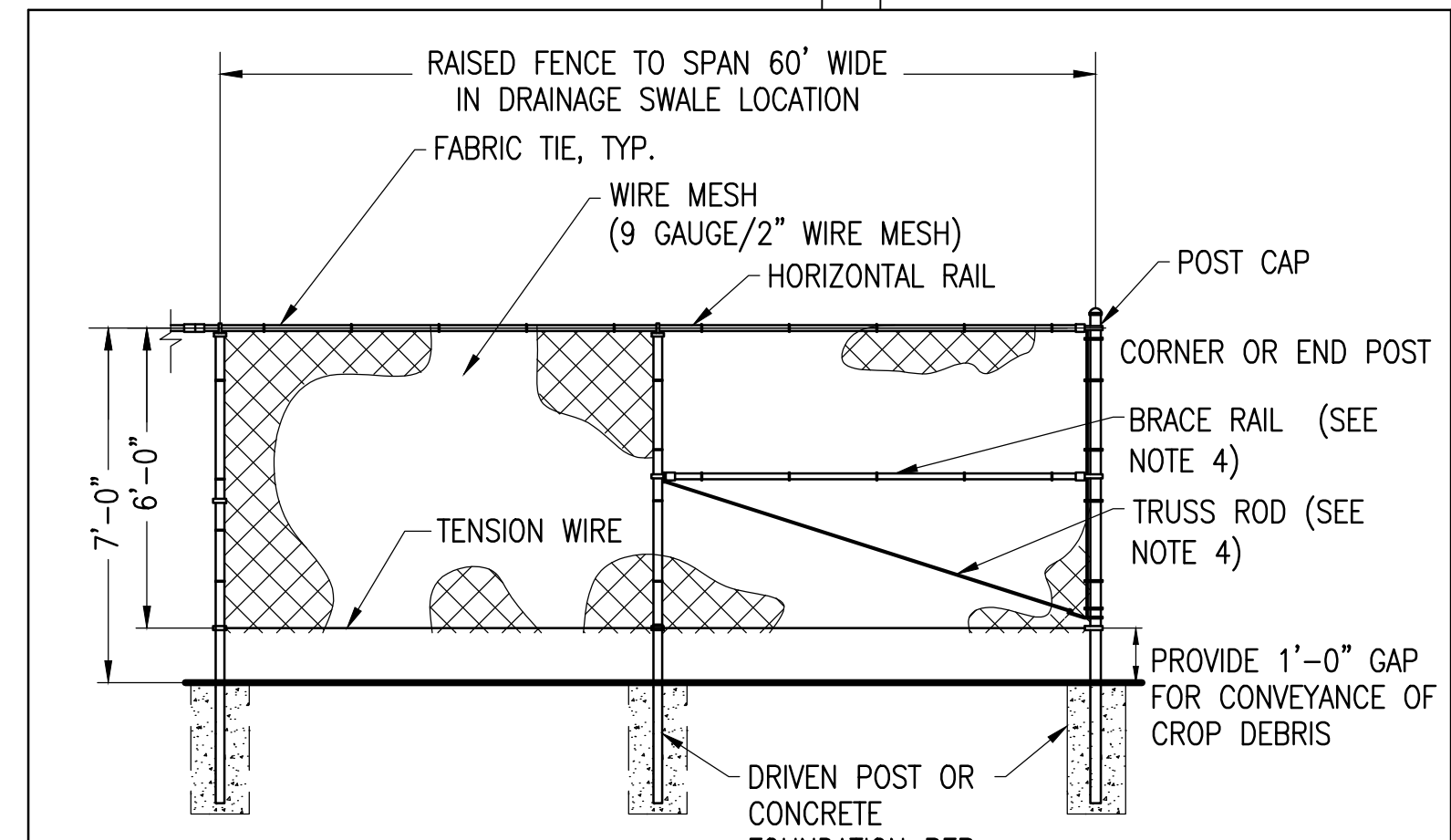
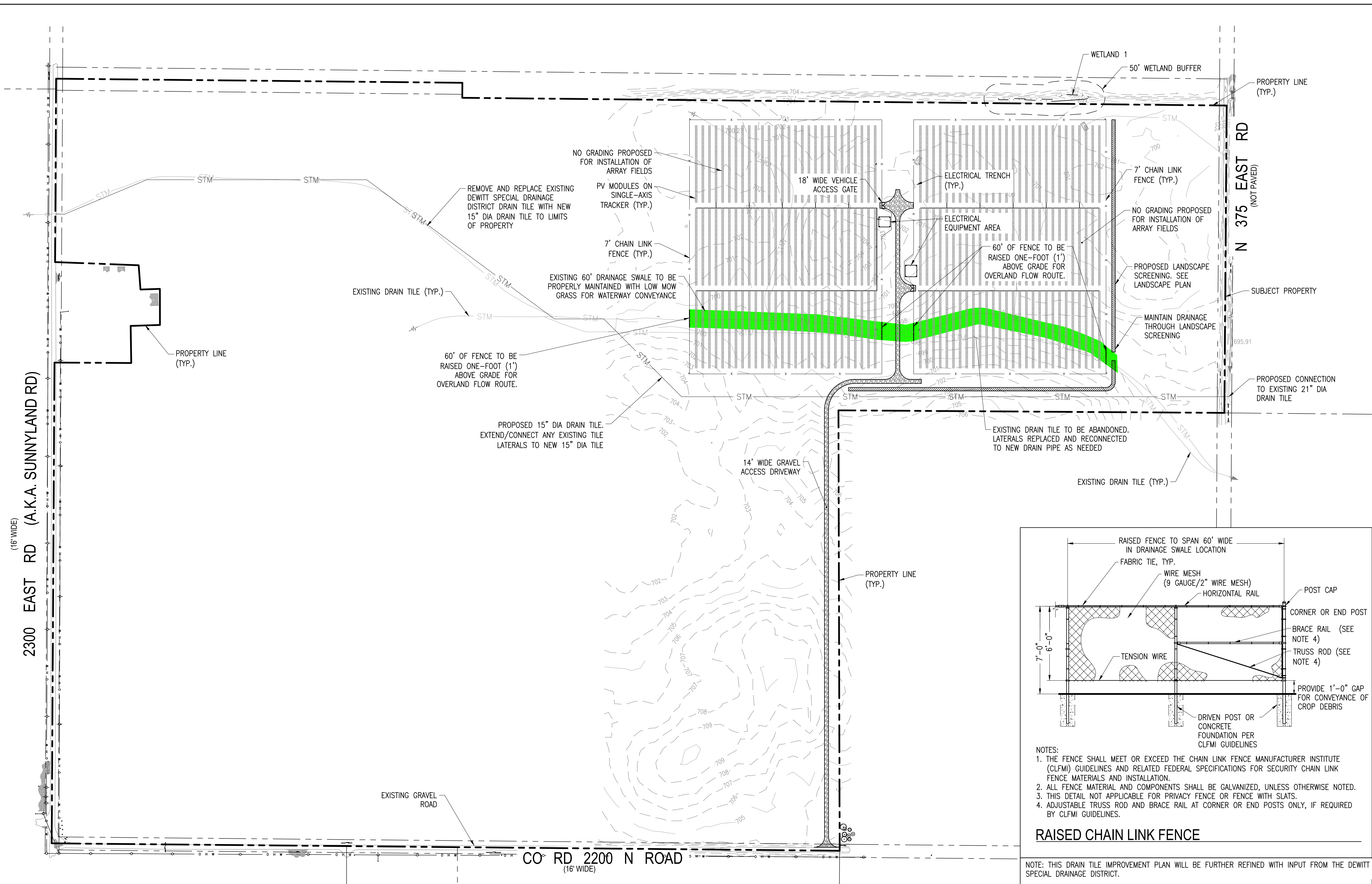

- NOTES:
1. THE FENCE SHALL MEET OR EXCEED THE CHAIN LINK FENCE MANUFACTURER INSTITUTE (CLFMI) GUIDELINES AND RELATED FEDERAL SPECIFICATIONS FOR SECURITY CHAIN LINK FENCE MATERIALS AND INSTALLATION.
 2. ALL FENCE MATERIAL AND COMPONENTS SHALL BE GALVANIZED, UNLESS OTHERWISE NOTED.
 3. THIS DETAIL NOT APPLICABLE FOR PRIVACY FENCE OR FENCE WITH SLATS.
 4. ADJUSTABLE TRUSS ROD AND BRACE RAIL AT CORNER OR END POSTS ONLY, IF REQUIRED BY CLFMI GUIDELINES.

RAISED CHAIN LINK FENCE

NOTE: THIS DRAIN TILE IMPROVEMENT PLAN WILL BE FURTHER REFINED WITH INPUT FROM THE DEWITT SPECIAL DRAINAGE DISTRICT.

DRAINAGE EXHIBIT

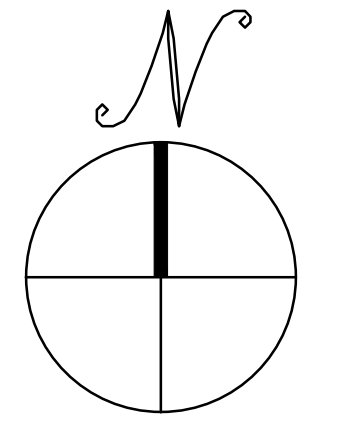
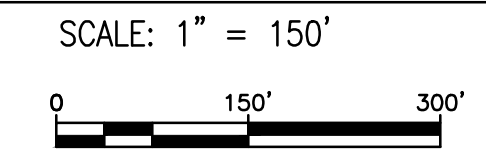

C:\Users\Memmoor\Box Sync\Software\Projects\2240 N 375 East Road - Platt\329 East 2200 North Rd-Platt_11-26-18 MAS